

[www.cometalserramenti.it](http://www.cometalserramenti.it)



**Cometal**  
FINESTRE D'AUTORE

*Windows  
of your dreams*



*Digital passport Window Identity*

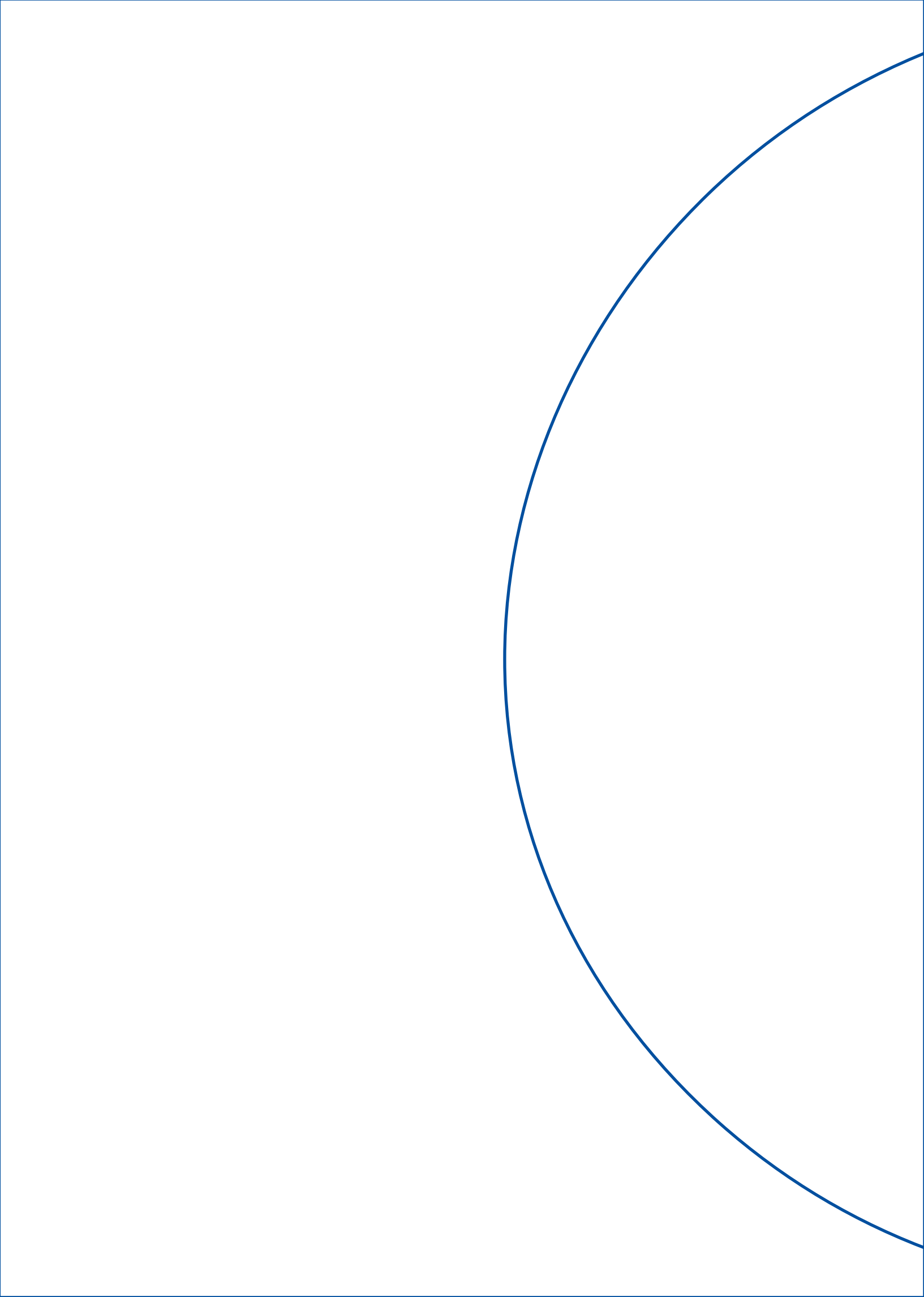

*When dreams  
come true...*

*Our production line*





MADE WITH THE BEST AUTOMATIC CNC WORK CENTRES,  
OUR PRODUCTION LINE DELIVERS MAXIMUM PRECISION AND EFFICIENCY

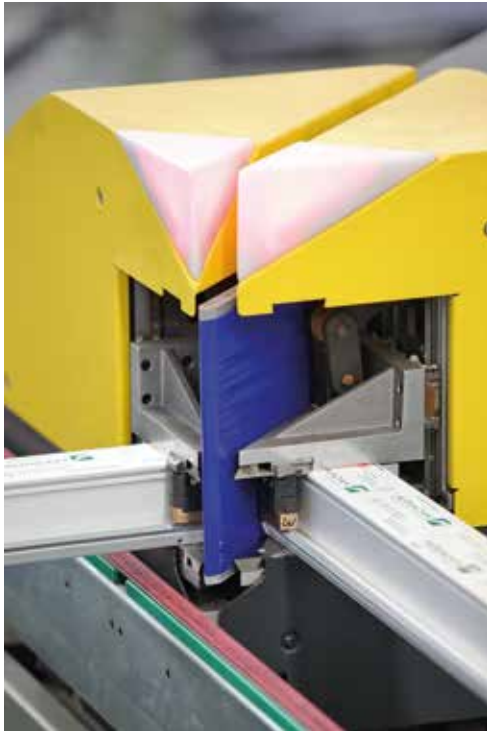

## ABOUT US

COMETAL was born as a small company in 1981, first focused on the production of aluminium frames, targeted to the factory's own geographical area, and afterwards pushed towards enlarging the production given the growing request of the products. The new 8000 sq.m. production area opens in 2005; it features a completely computerised management of the whole production line which sharpens the efficiency of each step of the process. The line is managed by the most sophisticated systems now on the market and their constant updates allows for an improving efficiency throughout time.

The manufacturing plant is a blend of electro-mechanic technology and human skill in order to create high-quality aesthetic finishes. Flexibility has always been a great point for us: we've always aimed to bend industrial growth (necessary for improvement) to our needs, not the other way around.

This big effort we put into work allowed us to set aside from the competition, not only for the wide variety of products we offer but also for the many applications they can be used for.

COMETAL WAS AWARDED WITH PLENTY OF **QUALITY CERTIFICATES**,  
SHOWING THE QUALITY OF THE SERVICE PROVIDED THROUGHOUT ITS HISTORY





# Think Eco

## Eco-friendly behaviour as the best energy source

Avoiding waste and useless heat loss is the best way to properly use energy. Thanks to Cometal frames, you'll be able to significantly reduce heating costs and your carbon footprint: a true investment that will shortly be offset and will add value and comfort to your house

## Eco-compatibility: a worth mindset

All Cometal frames are made from recycled materials and could be used in the future to make different products. Furthermore, our production process brags an extremely low environmental footprint. For these reason, choosing a Cometal frame is twice the right choice for environmental care.





# Digital Passport

WITH **WINDOW IDENTITY**,  
EVERY ONE OF YOUR WINDOWS IS SPECIAL  
YOU KNOW WHAT YOU BUY,  
YOU CAN TRUST US



**Window Identity**

Développé juste pour vous

If you want to check what stands behind a window, you can. You just need to fill the dedicated slot on the [www.windowidentity.com](http://www.windowidentity.com) website with the 14-digit code that you find on the label of the product.

You'll have all the details regarding that specific window.

The code is, in fact, the DNA of your frame; with that code you can track back to the birth of that window, the type, material/s it's made of, performance label, manufacturer, seller.

You'll also find all the informations for the cleaning, maintenance and placing of that window.

Also, if you encounter any problems or defections, you can ask for assistance to professionals with non need of inspection. Window identity tells you everything about your window.

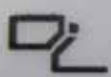

[windowidentity.com](http://windowidentity.com)



0A00000  
0018895

The peak technology available today,  
all within your window





# SMART FACTORY

A complete made-in-Italy production, from A to Z...  
We work every day on our 4.0 factory every day, that shows the excellence of Italian products all over the world with its results.

Cometal windows stylish and technological to guarantee comfort; performing and mainly showing the reliability and superior quality of the Made in Italy throughout time.  
The peak technology available in frames today, identified through the digital passport window identity (more information on our website)

## 4.0 FACTORY



## An iconic case

Since 2001, Cometal from Cuneo uses the FP SUITE solution proposed by Emmegisoft successfully. From this, come big organising, efficiency, quality and customer service upsides.  
By Alberto Schoenstein

In the world of window frames, there is the constant request made by specialized companies of complete software solutions that can cover all the production areas of a factory. Cometal, originally from Monesiglio (CN), which makes Pvc, aluminium, alu-wood frames and aluminium blinds, is, in this sector, the excellence. It owns a long-going work towards the development of informatics solutions thought towards the creation of a more digitalised working experience. It features a major attention for making the whole production process more digital, by integrating all the process' steps: technical, commercial and production. In order to do this, Cometal chose the Emmegisoft software.

To the day, it has adopted FP PRO, the main FP SUITE software that features the vital functions for every window frame company: from the design, orders' definition and calculations, purchase management, to the making of the workshops working schedule and CE marking management.

Since 2007, Cometal also uses FP DEALER, the program linked to FP PRO used to work on quotes and orders based on set pricing lists: FP GEST, window frames' specific FP PRO and FP DEALER. This allows for organising the whole production process of the factory.







For each one of the resources, a proper calendar is set in order to make sure the tasks and orders are completed in time, staying within the excellence and organization criteria. In addition to that, the FP Workshop (the added module to the FP PRO), is always there to support the workers and scan the production datas. Cometal is an example of excellence in the use of specific software in the window frames' world.

We interviewed Maurizio Salvatori, in charge of the Information technology in Cometal srl. He showed us the different use of softwares in the factory: "Thanks to the informatization of the whole production line, we can use these technologies in every single one of the areas of the factory. This is a great advantage for Cometal: high quality of the product and competitive approach to the market by deleting all the downtime. Once this is done, each phase of our process gets optimised, allowing for the best quality and service".

## SOME ADVANTAGES OF THE FP SUITE SOFTWARE

- The sales team can create a complete offer without having to ask information to the technical department
- The sales team can work while constantly being updated regarding choices and prices
- One only tool for designing aluminium, au-wood and PVC frames
- "open" tool that leaves room for easily customising archives and technical solutions
- Easy access to detail regarding orders and state of the production process
- Saving on production time and cost

**There is a long-running relationship between you and Emmegisoft / Emmegi: why did you choose these partners and which solutions are you adopting at the moment?**

"We use Emmegisoft softwares in all areas and we have a great deal of Emmegi machines in the Pvc and Aluminium frame sector. Thanks to the software, we can improve the flow and the timing. FP SUITE is a unique tool we use for designing aluminium, alu-wood and Pvc frames. It is quite "open" and it allows us to customise datas in archive and technical solutions quite easily. Furthermore, we can easily design non-standard products for particular needs of our customers. Thanks to FP SUITE we made production more efficient raising the quality of the products. This result is key for a positive image of the Cometal brand.

**What are the advantages of having full control of the supply chain for a company? Are you planning on making further steps towards a more integrated software system like digitalising the sale process?**

"Up to now the advantages are mainly bound to us being able to give our sellers a platform where to properly operate with quotes. All the news regarding products are immediately available when placing any order. We have many retailers, constantly growing and spread around a wide area: Piedmont, Liguria, Lombardy but also France. Cometal works a lot on word of mouth and quality of the products. To the day, we have FP DEALER CLIENT but we are working on moving to VIEW, the new solution for the creation of a true virtual showroom by Voilap". "This is why we not only believe in the Emmegi machines, but also in softwares that can make the most out of that potential. And this is not all: thanks to this whole digital system, we can keep stockings and orders under control.

## COMETAL SRL

H.Q.: Monesiglio, Cuneo

Superficie : 8000 m2

Production : pvc and aluminium windows and aluminium blinds. The production of sliders is growing and becoming standard after being special products for a long time. Also rounded items and oversize ones.

Pvc and Aluminum machines: Emmegi

Software: Emmagisoft

Employees: around 45

Main office: 8000 sq. m.

Clients: retailers, show rooms

For example knowing the availability of an item, the value we have in stock, or a completed order. We are able to provide our customers with proper delivery times, based on our planning, evaluating the work loads before informing the clients and then checking for the progress of the orders so to save on time and cost of production.

**How was the learning curve of your software team and how do you find the Emmegisoft service assistance?**

Training has taken and takes place exactly when the system is installed and coordinated by me with great results, given the brilliant relationship with Emmegisoft: they are a group of professionals, always available with whom working is easy, fast and reliable."

Emmegisoft is a company of the Cifin Group, world leader in designing and manufacturing of aluminium, Pvc, steel and glass frames' production systems. A Software house targeted to all the activities related to the production line of aluminium, all-wood, Pvc, iron frames and curtain walls. ([www.emmegisoft.com](http://www.emmegisoft.com))

A photograph of a modern, single-story house at night. The house features large glass windows and doors that are illuminated from within, showing a well-furnished interior. The exterior has a flat roof and a wooden deck in the foreground. To the left, there is a striped outdoor sofa and some potted plants. The sky is a deep blue, indicating twilight.

*High-Craft windows*

MADE IN ITALY  
Since 1981





aluminium line  
**hinged**

*High-craft-design windows.  
Performing and modern,  
that show the excellence  
and superiority  
of the Made in Italy*



## TITANIUM

*"Light and performing"*

AVERAGE UW:2.00 W/M<sup>2</sup>K

UG STANDARD GLASS: 1.10 W/M<sup>2</sup>K

### TECHNICAL FEATURES

- Fixed frame size: 55mm
- Moving frame (door) size: 62mm
- Open hinge sealing system with a central EPDM seal within the fixed frame. Internal seal on moving doors
- Multipoint lock hardware with stock drop door and micro ventilation
- Stock Secustik handle impedes tampering of the window handle from outside.
- Stock 3-axis adjustable hinges



Air permeability:

**CLASS 4**



Water-tightness :

**CLASS E 1500**



Windproofness :

**CLASS C5**



## TITANE TOP

*"Unrivalled top class"*

AVERAGE UW: 1.60 W/M<sup>2</sup>K

UG STANDARD GLASS: 1.10 W/M<sup>2</sup>K

### TECHNICAL FEATURES

- Fixed frame size: 65mm
- Moving frame (door) size: 75mm
- Multipoint lock hardware with stock drop door and micro ventilation
- Stock Secustik handle impedes tampering of the window handle from outside.
- Open hinge sealing system with a central EPDM seal within the fixed frame. Internal seal on moving doors
- Stock 3-axis adjustable hinges



Air permeability:

**CLASS 4**



Water-tightness :

**CLASS E 1500**



Windproofness :

**CLASS C5**





A photograph of two young girls in pink dresses looking out a large window. The girl on the left is standing and looking out, while the girl on the right is sitting on the floor, also looking out. The window is decorated with string lights, and the scene is softly lit, suggesting a cozy indoor environment. The text is overlaid on the upper part of the image.

*Professionals for choice.  
We aim to make beautiful,  
properly designed windows,  
destined to last over time,*

# less is more

more light,  
up to 20% more than  
an equally-sized one.



## MINIMAL TITANE

*"The must have"*

AVERAGE UW: 1.40 W/M<sup>2</sup>K

UG STANDARD GLASS: 1.10 W/M<sup>2</sup>K

### TECHNICAL FEATURES

- Fixed frame size: 62mm
- Moving frame (door) size: 69mm
- Sealing system with fin-type central seal.  
Seal on the wing of the door and (on request)  
a 3rd acoustic seal between the frame and the door
- Multipoint lock hardware with stock drop door  
and micro ventilation
- Stock Secustik handle impedes tampering of the window  
handle from outside.
- Also with hidden hardware (90° rotating door)
- Hinges can be registered on a 3-axis basis



Air permeability:  
**CLASS 4**



Water-tightness:  
**CLASS E 1500**



Windproofness:  
**CLASS C5**



*A minimal and modern design for who loves squared lines  
A must-have for who wants to harvest light in their living space thanks  
o a very small frame presence.*

A large, abstract, continuous blue line that forms a complex, organic shape, resembling a stylized letter 'S' or a flowing ribbon, framing the central text.

aluminium line  
**SLIDING**





aluminium line  
**SLIDING**

*Aluminium line*  
SLIDING FRAMES





## SLIDING TOP CHROME

Average  $u_w$ : 1.80 W/m<sup>2</sup>k  
Ug standard glass: 1.10 W/m<sup>2</sup>k

- Great designing flexibility: up to 3 doors in the 2-rail configuration and up to 6 in the 3-rail one
- Rails withstand up to 220 kgs per door
- Hidden door on 1 or 2 rails available
- Up to 4 closure points
- Air permeability: Class 4
- Water-tightness: Class 7A
- Windproofness: Class C3



# *Aluminium line*

## SLIDING FRAMES

### RISE AND SLIDE TOP CHROME

Average uw: 1.80 W/m<sup>2</sup>k  
Ug standard glass: 1.10 W/m<sup>2</sup>k

- Great size mirrored doors
- Rails withstand up to 400 kgs per door
- Special rising servo-assisted system for smooth and light movements
- Hiding, angular closing elements for a completely free view available
- Air permeability: Class 4
- Water-tightness: Class E
- Windproofness: Class C4







# *Aluminium line*

## SLIDING FRAMES

### SLIDING FLIP AND SLIDE

Average  $u_w$ : 1.60 W/m<sup>2</sup>k  
Ug standard glass: 1.10 W/m<sup>2</sup>k

- High-crafted slide with all the same performance features as a hinge frame.
- Doors' profile can be round or squared in order to match perfectly with any living space and enhance its features
- Rails withstand up to 160 kgs per door
- Air permeability: Class 4
- Water-tightness: Class E
- Windproofness: Class C5



A large, abstract, continuous blue line that forms a complex, organic shape, resembling a stylized 'S' or a flowing ribbon, framing the central text.

# aluminium line **BLINDS**

An unbeatable variety of styles, given by a great  
expertise in the field and constant innovation





A full-page background image of a vast, deep blue ocean under a clear, light blue sky. The horizon line is visible in the middle of the frame. The water in the foreground shows some texture with small waves and white foam from a wake.

*A sea of options, eleven different models  
in order to guarantee the best solution  
for each living space*





aluminium line  
**blinds**





## ARIANNA SERIES

WIYH WALL WITH PERIMETER STROKE  
FIXED SLATS

- Variant with or without Genoese-style opening hatch
- Optional Palette with historical-type shape
- Snap-in espagnolette
- Hinged Door's width: 45 mm

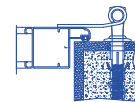
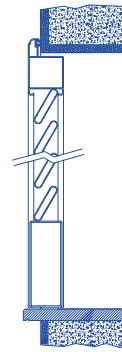

## ROSANGELA SERIES

PERIMETER FRAME  
FIXED SLATS

- Variant with or without Genoese-style opening hatch
- Optional Palette with historical-type shape
- Cremone bolt
- Fixed frame width: 45 mm
- Hinged Door's width: 45 mm

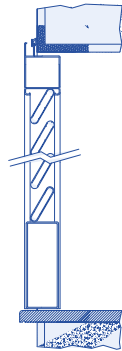

## ROSINA SERIES

WIYH WALL WITH PERIMETER STROKE.  
ADJUSTABLE SLATS

- Snap-in espagnolette
- Hinged Door's width: 45 mm

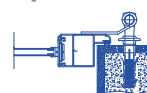
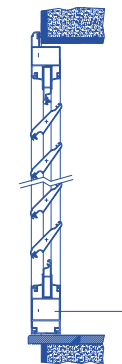



## VALENTINA SERIES

PERIMETER FRAME  
ADJUSTBLE SLATS

- Cremone bolt
- Fixed frame width: 45 mm
- Hinged Door's width: 45 mm

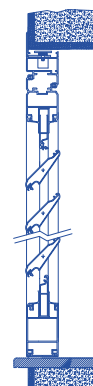

## JESSICA RAMONA SERIES

WIYH WALL OR PERIMETER FRAME  
FIXED SLATS, WIDTH 32 MM

- Variant with or without Genoese-style opening hatch
- Cremone bolt
- Hinged Door's width: 30 mm

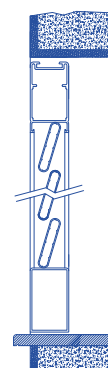

## CELESTINA SERIES

WIYH WALL WITH PERIMETER STROKE

- Vertical veneered panel, width 30mm (horizontal on request)
- Chance of having a 10mm panel with a perimetrical frame for decoration
- Snap-in espagnolette
- Hinged Door's width: 45 mm

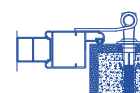
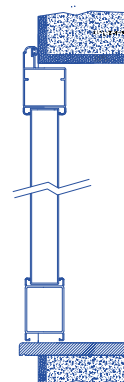



## MIRANDA SERIES

DARK WIIH WALL  
ADJUSTBLE SLATS

- Sliding door
- Available version with profile for ancient look
- Cremone bolt
- Hinged Door's width: 45 mm

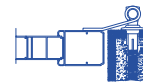
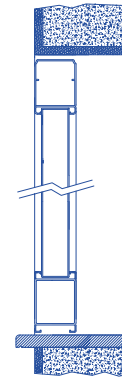

## RODICA SERIES

DARK WITH PERIMETER STROKE

- Available version with profile for ancient look
- Cremone bolt
- Fixed frame width: 45 mm
- Hinged Door's width: 45 mm

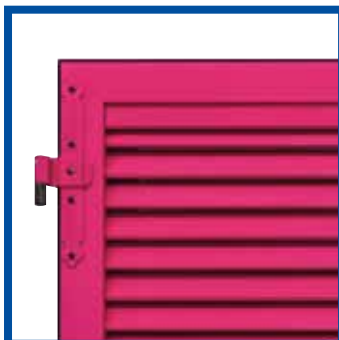
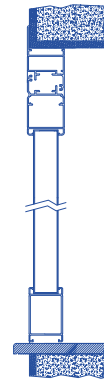

## GRAZIANA SERIES

WIIH WALL  
ADJUSTBLE SLATS

- Variant with or without Genoese-style opening hatch
- Optional Palette with historical-type shape
- Sliding door
- Cremone bolt
- Hinged Door's width: 45 mm

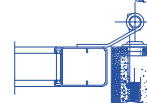
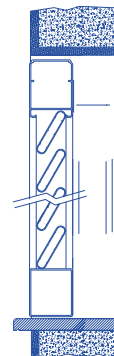

**SADDLES AND ACCESSORIES MATCHING ON 9 STOCK COLORS**  
**RAL 9010 - 1013 - 6005 - 6005R - 7001 - 8014 - 8017 - 8017R**  
**(ALL OTHER COLORS ON REQUEST)**  
**PRE-SHEARED MATCHING ALL OTHER COLORS ON REQUEST**



# *Kosmica Series*



# *armoured blind*

The only safe blind that shelters you not only from the sun

*Kosmic protects you, for sweet dreams*

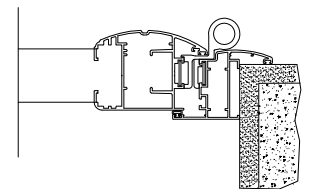
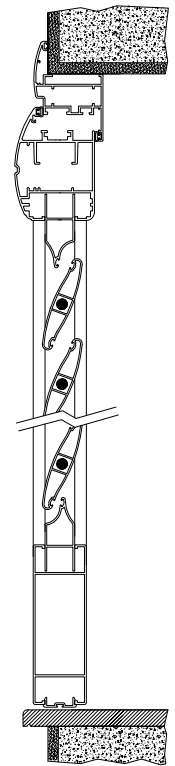

- ▶ PERIMETER FRAME
- ▶ GALVANISED, ANTI-THEFT STEEL ROD IN EACH SLAT
- ▶ HINGES ARE MADE WITH THRUST PROTECTION BOLTS
- ▶ 3-POINT LOCK WITH INNER CYLINDER AND HANDLE
- ▶ CHOICE BETWEEN FIXED OR ADJUSTABLE SLATS
- ▶ ROUND SHAPES FOR A UNIQUE DESIGN

Only 1-2 doors

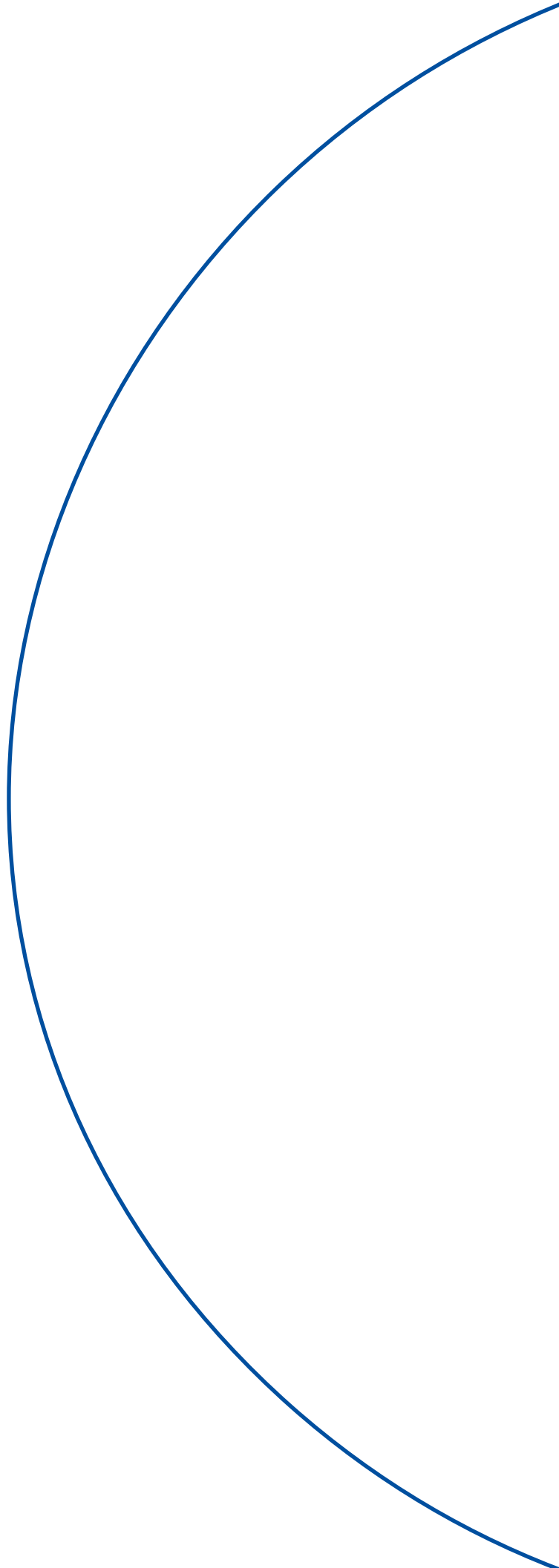



A large, abstract, continuous blue line that forms a complex, organic shape, resembling a stylized 'S' or a flowing ribbon, framing the central text.

pvc line

# HINGED FRAMES

en classe S climats rudes



## *A matter of style that makes a difference*

When technology meets elegance:  
perfect colour match between seals and frame surface

- White on white
- Ivory on ivory and modern covering film
- Caramel or brown on wood-colour

*Maximum attention to details...*





*Pvc for high-quality doors  
and windows strictly  
Made in Italy*



## ISIDE PLUS Series

*"Absolute Performance"*

AVERAGE UW: 1.40 W/m<sup>2</sup>K

UG STANDARD GLASS: 1.10 W/m<sup>2</sup>K

### TECHNICAL FEATURES

- 70mm frame, 5 chambers
- 80mm door, 7 chambers
- N°3 seals in EPDM, weather proof and with a high-elastic memory
- Multipoint lock hardware with stock drop door and stock micro ventilation
- Stock Secustik handle impedes tampering of the window handle from outside
- Stock 3-axis adjustable hinges
- 20/10mm armored, galvanised steel metallic structure each door and perfectly snug frame



Air permeability:  
**CLASS 4**



Water-tightness  
**up to E 1500**



Windproofness  
**up to C5**









## VENERE PLUS Series

*"Bigger structure, higher performance"*

AVERAGE UW: 1.40 W/m<sup>2</sup>K  
UG STANDARD GLASS: 1.10 W/m<sup>2</sup>K

### TECHNICAL FEATURES

- 80mm frame, 6 chambers
- 80mm door, 6 chambers
- N°2 seals in EPDM, weather proof and with a high-elastic memory
- Multipoint lock hardware with stock drop door and stock micro ventilation
- Stock Secustik handle impedes tampering of the window handle from outside.
- Stock 3-axis adjustable hinges
- 20/10mm armored, galvanised steel metallic structure each door and perfectly snug frame



Air permeability:  
**CLASS 4**



Water-tightness  
**up to E 1500**



Windproofness:  
**up to C5**







## VENERE Series

*"Shape and structure"*

AVERAGE UW: 1.45 W/m<sup>2</sup>K

UG STANDARD GLASS: 1.10 W/m<sup>2</sup>K

### TECHNICAL FEATURES

- 70mm frame, 5 chambers
- 80mm door, 6 chambers
- N°2 seals in EPDM, weather proof and with a high-elastic memory
- Multipoint lock hardware with stock drop door and stock micro ventilation
- Stock Secustik handle impedes tampering of the window handle from outside.
- Stock 3-axis adjustable hinges
- 20/10mm armored, galvanised steel metallic structure each door and perfectly snug frame



Air permeability  
**CLASS 4**



Water-tightness  
**up to E 1500**



Windproofness  
**up to C5**





## VENERE MINIMALE Series

*"Performance and light"*

AVERAGE UW: 1.35 W/m<sup>2</sup>K  
UG STANDARD GLASS: 1.10 W/m<sup>2</sup>K

### TECHNICAL FEATURES

- 70 mm frame, 5 chambers
- 70 mm door, 6 chambers
- N°2 seals in EPDM, weather proof and with a high-elastic memory
- Multipoint lock hardware with stock drop door and stock micro ventilation
- Stock Secustik handle impedes tampering of the window handle from outside.
- Stock 3-axis adjustable hinges
- 20/10 mm armored, galvanised steel metallic structure each door and perfectly snug fram



Air permeability  
**CLASS 4**



Water-tightness  
up to **E 1500**



Windproofness  
up to **C5**

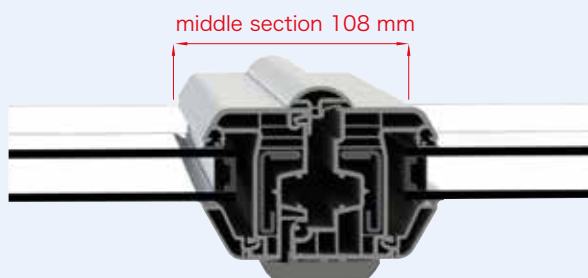

## VENERE TOTAL COLOR

*"A perfect technology and elegance combination"*



ARTICO



CHIARA



CERISIER



NOYER CLASSIC



TUNDRA



SAHARA



Enough with the colour differences between the inner and outer side of the window. Today we can provide a 4-side total coating for a high aesthetic final result

*A new  
coating technology  
for high-craft  
windows*





# Cometal Pvc Windows

ENSURE YOUR WINDOWS ARE  
' CLASS S ' - SEVERE CLIMATE



The market offers low-cost products made with 'type-M' frames, which actually DO NOT meet the standards, but are also NOT as beautiful and do NOT guarantee good durability, which is a 'must have' with new windows.

It seems that not all PVC is the same!

Ask for well-made  
'Class S' ITALIAN PVC



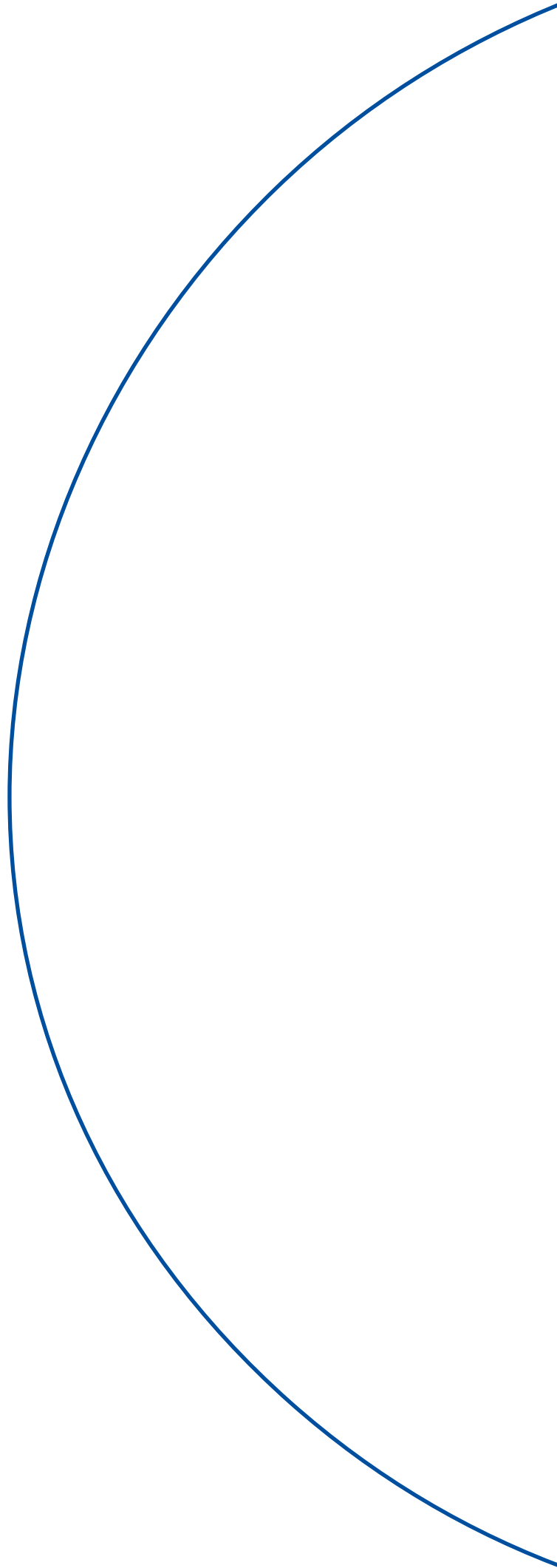

A large, abstract, continuous blue line that forms a complex, organic shape, resembling a stylized 'S' or a flowing ribbon, framing the central text.

pvc line

# sliding doors

In S class for severe climates

## Sliding IN'LINE PARALLEL

Average  $U_w$ : 1.60 W/m<sup>2</sup>k  
 $U_g$  standard glass: 1.10 W/m<sup>2</sup>k

- High level of versatility, in-line technology allows for a great variety of solutions, from 2 to 6 sliding doors
- Smooth and light movements thanks to aluminium rails and special tracks
- Peculiar frame shape that makes it compatible with any kind of wall
- Chance of adding an integrated mosquito net
- Air permeability: Class 3
- Windproofness: A2
- Minimal and elegant aesthetics







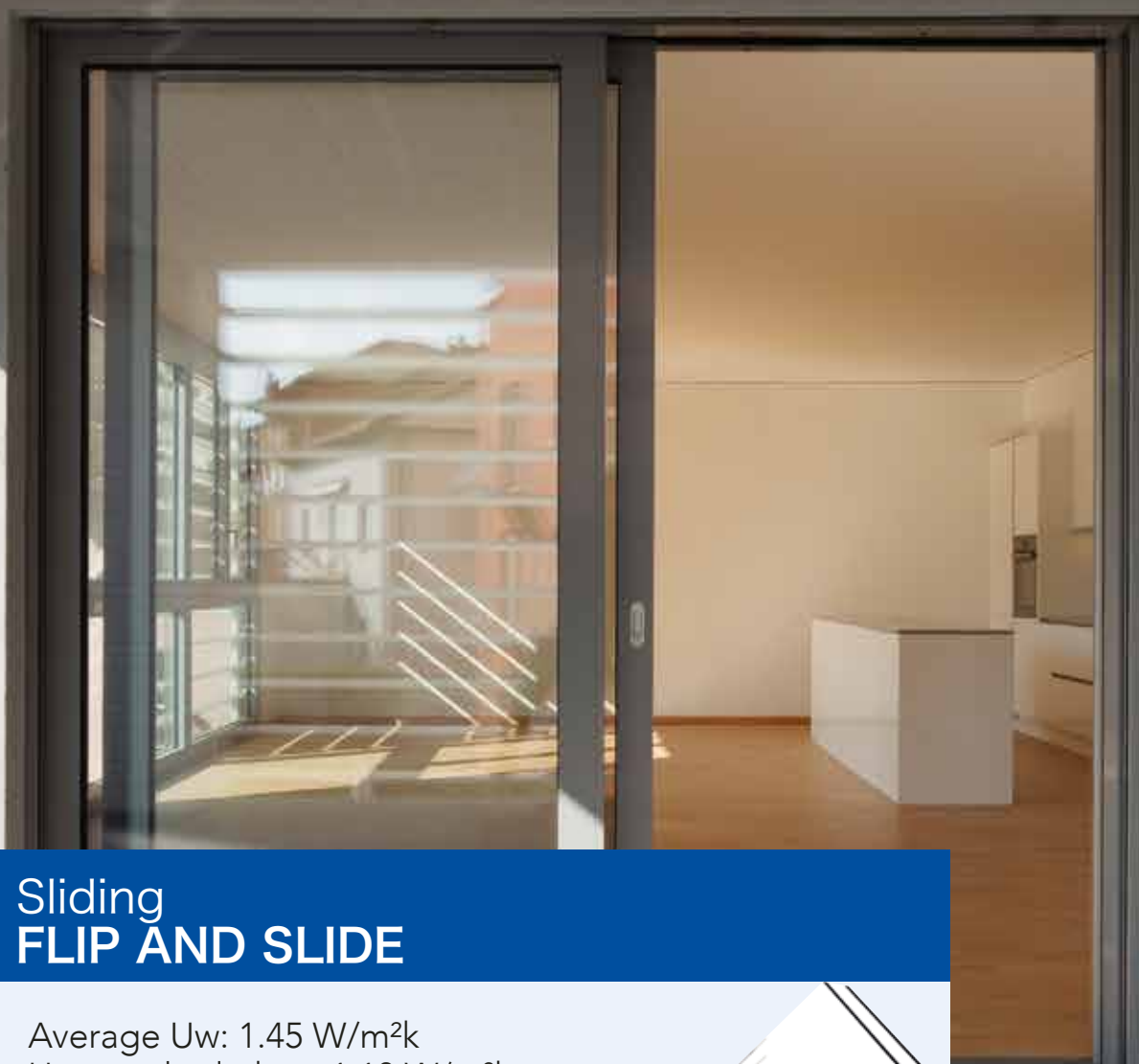

## Sliding **FLIP AND SLIDE**

Average  $U_w$ : 1.45 W/m<sup>2</sup>k  
 $U_g$  standard glass: 1.10 W/m<sup>2</sup>k

- Minimal and modern design that provides great thermal performance
- Maximum rail load: 160 kg per door
- 2 or 3 seals available
- Air permeability = Class 4
- Water-tightness = Up to E1500
- Windproofness = Up to C5









## Sliding FLIP AND SLIDE

Average  $U_w$ : 1.30 W/m<sup>2</sup>k

$U_g$  standard glass: 1.10 W/m<sup>2</sup>k

- Thanks to its air and water tightness high performance, it stays safe and reliable throughout time
- Perfect for big windows and wide surfaces. It guarantees brightness to the living space
- Easy opening system thanks to its handle. Easy to operate even in high-weight circumstances
- Great structural strength given by the armoured door
- Air permeability = Class 4
- Water-tightness = Class 5A
- Windproofness = B2







We take care of your windows from the beginning to the end.  
We make sure we'll adopt and use the best materials, starting from the feedstock,  
to the hardware, till the smallest components and accessories.  
When we are done with your windows, you won't be able to see inside  
and understand what they are made of.

A window is not just a window.  
They are not all the same.

NO SURPRISES WITH COMETAL  
GIVEN THE DIGITAL PASSPORT

Everything you buy meets all the premises we showed

Beautiful, safer, more insulated houses







COMETAL WINDOWS  
EXPERTISE, INNOVATION,  
QUALITY AND CARE



*REGULAR WINDOWS OF COMETAL WINDOWS:  
CHOOSE WISELY. CHOOSE COMETAL  
SINCE 1981, OUR EFFORT IS DEDICATED TO MAKING  
YOUR HOUSES MORE BEAUTIFUL.  
WITH PASSION, DRIVE AND COMMITMENT.*

*EVERY HOUSE HAS A STORY, AND EVERY SINGLE  
OF OUR CUSTOMERS IS SPECIAL FOR US.  
THIS MAKES OUR JOB IMPORTANT AND  
A NEW GREAT CHALLENGE EVERY DAY*

*The End*





*High-Craft windows*

MADE IN ITALY

since 1981

AUTHORISED RETAILER



**Cometal**  
FINESTRE D'AUTORE

Cometal S.r.l. Via Bertole, 29  
12077 Monesiglio (CN)  
Tel. +39 0174 900507 Fax +39 0174 92043  
info@cometalserramenti.it  
**www.cometalserramenti.it**







